

DORMANT RENOVATION (options identiques pour le dormant 3 rails)

type pose

R1

couvre joint de 26
réf : CJ30
bavette 30 x 22
réf : BC001

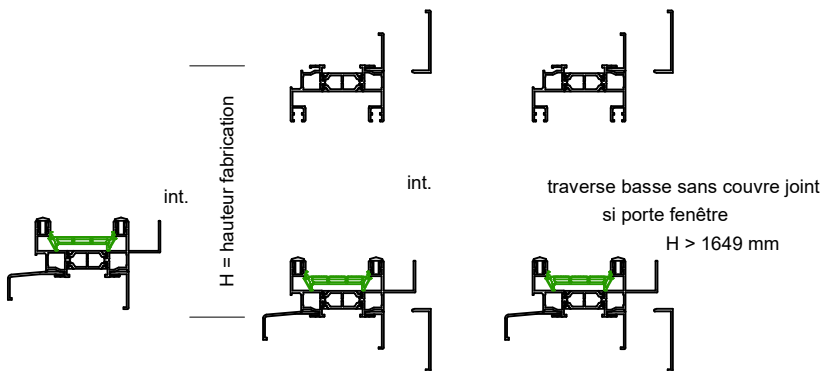

type pose

R2

couvre joint de 66
réf : CJ70
bavette 30 x 22
réf : BC001

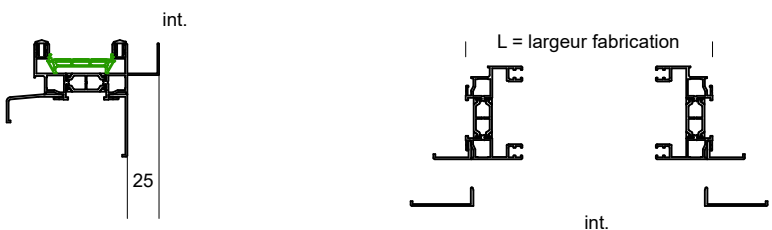

DORMANT POUR POSE EN NEUF DOUBLAGE DE 120, 140, 160, 180 et 200 mm

(options différentes pour le dormant 3 rails voir catalogue tech)

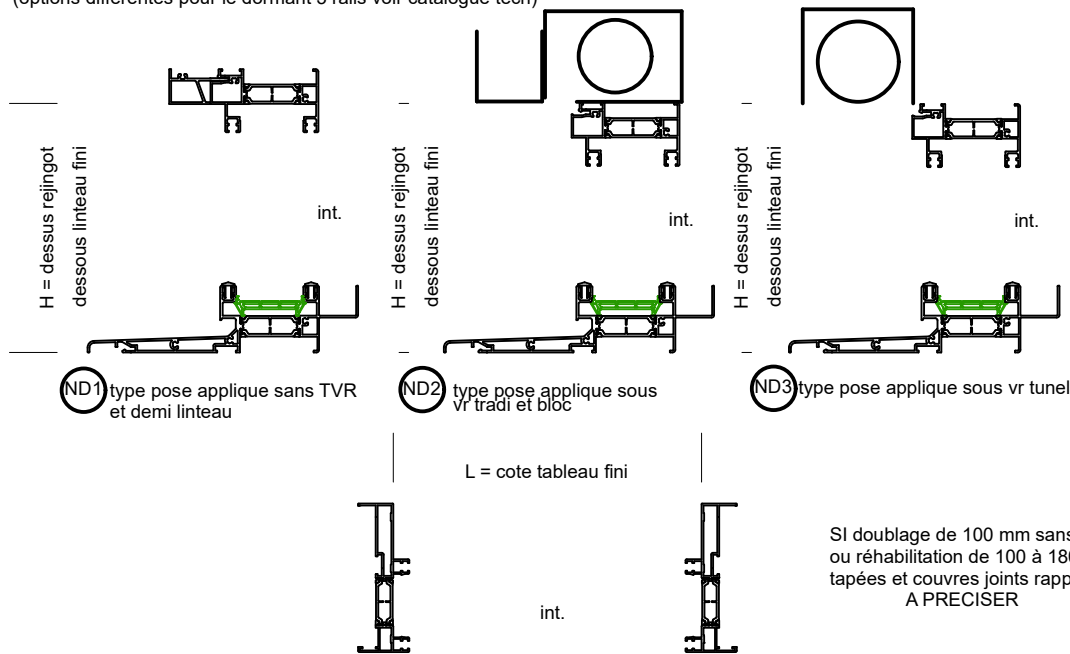

Si doublage de 100 mm sans TVR ou réhabilitation de 100 à 180 mm tapées et couvre joints rapportés A PRECISER

DORMANT POUR POSE APPLIQUE TUNEL OU FEUILLURE (options identiques pour le dormant 3 rails)

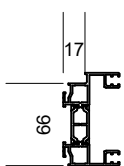

int.

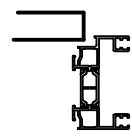

A1

type pose applique

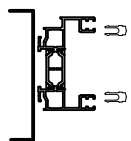

T1

type pose tunel

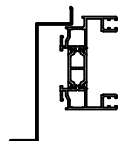

F1

type pose feuillure

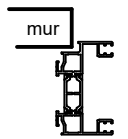

int.

L = largeur fabrication = largeur commande

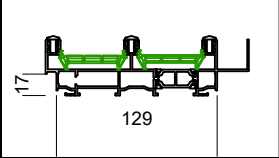

int.

L = largeur fabrication = largeur commande

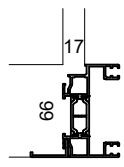

int.

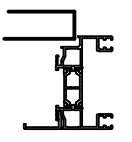

A2

type pose applique

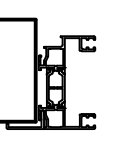

T2

type pose tunel

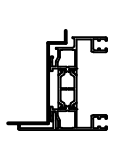

F2

type pose feuillure

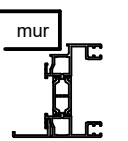

int.

L = largeur fabrication = largeur commande

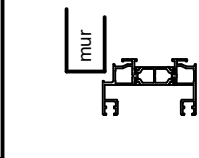

int.

H = hauteur fabrication = hauteur commande

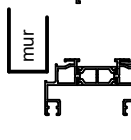

int.

H = hauteur fabrication = hauteur commande

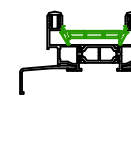
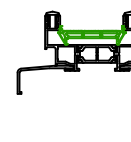

traverse basse sans couvre joint si porte fenêtre
H > 1649 mm

COUVRE JOINT DE 30 mm SUR 4 COTES

DESIGNATION CHASSIS

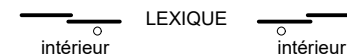

VSD

Vtl de Service à Droite Vtl de Service à Gauche

VSG

CC = fenêtre coulissante

H < à 1649 mm

PFC = porte fenêtre coulissante

H > à 1649 mm

- CC2V2R = fenêtre coulissante 2 vtx 2 rails
- PFC2V2R = porte fenêtre coulissante 2 vtx 2 rails
- CC3V2R = fenêtre coulissante 3 vtx 2 rails
- PFC3V2R = porte fenêtre coulissante 3 vtx 2 rails
- CC4V2R = fenêtre coulissante 4 vtx 2 rails
- PFC4V2R = porte fenêtre coulissante 4 vtx 2 rails
- CC3V3R = fenêtre coulissante 3 vtx 3 rails
- PFC3V3R = porte fenêtre 3 vtx 3 rails
- CCGAL1V1R = fenêtre galandage 1 vtl 1 rail
- PFCGAL1V1R = porte fenêtre galandage 1 vtl 1 rail
- CCGAL2V1R = fenêtre galandage 2 vtx 1 rail
- PFCGAL2V1R = porte fenêtre galandage 2 vtx 1 rail
- CCGAL2V2R = fenêtre galandage 2 vtx 2 rails
- PFCGAL2V2R = porte fenêtre galandage 2 vtx 2 rails
- CCGAL4V2R = fenêtre galandage 4 vtx 2 rails
- PFCGAL4V2R = porte fenêtre galandage 4 vtx 2 rails